



Outstanding Functionality The Very Best in its Class

New!



Horizontal Machining Center

H.Plus-300

UPGRADED SPECIFICATION

- Y-axis stroke increased to **560 mm** (22.04 in.) [+60 mm (2.36 in.)]. Max work piece envelope increased to **ø530 x H760 mm** (ø20.86 x H29.92 in.) [+H60 mm (2.36 in.)]. No competitor machine has a larger working envelope.
- Rapid traverse rate (X/Y/Z) increased to **60 m/min** (2,362 ipm) [+10 m/min (393.7 ipm)]. **51 tool** ATC as standard [+20 tools] incorporating a new Matsuura developed high speed ATC tool indexing system.
- High speed indexing increased to **100 min⁻¹** [+50 min⁻¹], the rotary table with DD Motor can be supplied as option.

SUPERB RELIABILITY

- Thermal Displacement Compensation as Standard. Auto Grease Supply (Spindle & All axes). Superb Swarf Management - integrated & ergonomic design. Matsuura Designed X-Type APC Door - no swarf traps.

User Friendly

- Min distance from spindle to pallet center reduced to **70 mm** (2.75 in.) [-50 mm (1.96 in.)]
- Floor space reduced by 10% to **7.8 m²**.
- Supplied with powerful NC **Matsuura G-Tech 30i** or **Matsuura G-Tech 840Di**

H.Plus-300 Pallet

unit : mm (inch)

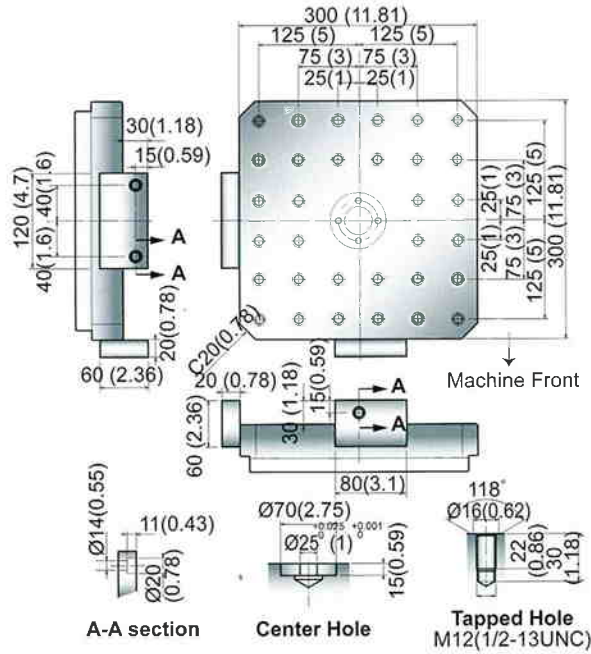

H.Plus-300 Outline

unit : mm (inch)

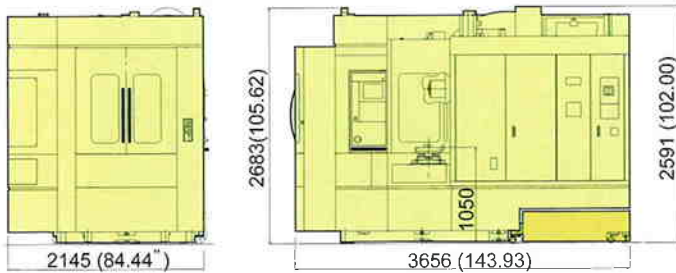

H.Plus-300 Floor Plan

unit : mm (inch)



H.Plus-300 Standard Machine Specifications

Travel		
X-axis	mm (in.)	500 (19.68)
Y-axis	mm (in.)	560 (22.04)
Z-axis	mm (in.)	500 (19.68)
B-axis	deg	360
Distance from Pallet Surface to Spindle Center	mm (in.)	80 ~ 640 (3.14 ~ 25.19)
Distance from Pallet Center to Spindle End	mm (in.)	70 ~ 570 (2.75 ~ 22.44)
Table		
Working Surface	mm (in.)	300 x 300 (11.81 x 11.81)
Loading Capacity	kg (lb.)	250 (551 lb.)
Max. Work Size	mm (in.)	ø530 x H760 (ø20.86 x H29.92)
Spindle		
Spindle Speed	min ⁻¹	50 ~ 15,000
Spindle Bearing Lubrication		Auto Grease Supply
Max. Spindle Torque	Nm/min ⁻¹	120 / 1,200
Feedrate		
Rapid Traverse (X/Y/Z)	mm/min (ipm)	60,000 (2,362.2)
Feedrate (X/Y/Z)	mm/min (ipm)	1 ~ 60,000 (0.1 ~ 2,362.2)
Automatic Tool Changer		
Type of Tool Shank		JIS B 6339 toolshank 40T
Type of Retention Knob		JIS B 6339 pullstud 40P
Tool Storage Capacity		51
Max. Tool Diameter	mm (in.)	90 (3.54) <small>When the pockets on both side are empty</small> 150 (5.90)
Max. Tool Length	mm (in.)	300 (11.81)
Max. Tool Mass	kg (lb.)	8 (17)
Tool Change Time : Chip to Chip	sec.	2.6 sec. (target)
Power Sources		
Power Voltage	kVA	50 <small>In case of equipping with 51 tool ATC & rotary table</small>
Compressed Air Supply	NL/min	400
Tank Capacity		
Coolant Tank	L (gal.)	530 (140)
NC System		
Control System		Matsura G-Tech 30i Matsura G-Tech 840Di
Standard Accessories		
<ol style="list-style-type: none"> 1) Total Enclosure Guard with Ceiling 2) Synchronised Tapping Function 3) AD-TAP Function (High-Speed function) 4) IPC Function 5) Spindle Oil Cooler 6) Auto Grease Supplier for Spindle 7) Feed axis grease auto supply 8) Swarf Rear Disposal 9) Chip Flow 10) Spindle Overload Protection 11) M-Code Counter (9 M-Code) 12) Work Light 13) Standard Mechanical Tools and Tool Box 14) Machine Colour Paint 15) Levelling Plate and Bolts (not Foundation Pad) 16) Handy Man II F 17) Install CD-R for Program/Edit on Memory Card only for Matsura G-Tech 30i 18) Safety Interlock 19) Thermal Displacement Compensation 		



website : www.matsura.co.jp
e-mail : webmaster@matsura.co.jp

ISO9001 ISO14001 OHSAS18001

MATSUURA MACHINERY CORPORATION

1-1 Urushihara-cho Fukui City 910-8530 Japan <Tel> +81-776-56-8106 <Fax> +81-776-56-8151

MMTS CORPORATION

65 Union Avenue, Suite2, Sudbury Massachusetts 01776 U.S.A. <Tel> +1-978-443-5388 <Fax> +1-978-443-9524

MATSUURA EUROPE GmbH

Otto-Von-Guericke-Ring 10a 65205 Wiesbaden-Nordenstadt Germany <Tel> +49-6122-7803-80 <Fax> +49-6122-7803-33

MATSUURA MACHINERY GmbH

Otto-Von-Guericke-Ring 10a 65205 Wiesbaden-Nordenstadt Germany <Tel> +49-6122-7803-0 <Fax> +49-6122-7803-33

MATSUURA MACHINERY PLC

Beaumont Centre Whitwick Business Park, Coalville Leicestershire LE67 4NH England <Tel> +44-1530-511-400 <Fax> +44-1530-511-440

ELLIOTT MATSUURA CANADA INC.

2120 Buckingham Road Oakville Ontario L6H 5X2 <Tel> +1-905-829-2211 <Fax> +1-905-829-5600